

## DESIGN STUDIO + WITH BRENDA J. BROWN

In fall 2009, I taught a master's level landscape architecture studio at the University of Manitoba. My intention was not to divert students to lighting design, or even to inculcate agility in selecting lighting equipment. I sought rather to prepare them for meaningful interactions with lighting designers and to enhance their awareness of light and its possibilities.

[READ THE WHOLE ARTICLE](#) [click](#)

**B**

DEVIN SEGAL WAS DRAWN TO A PAIR OF ASSINIBOINE RIVER BRIDGES AND THE SPACES BETWEEN THEM.

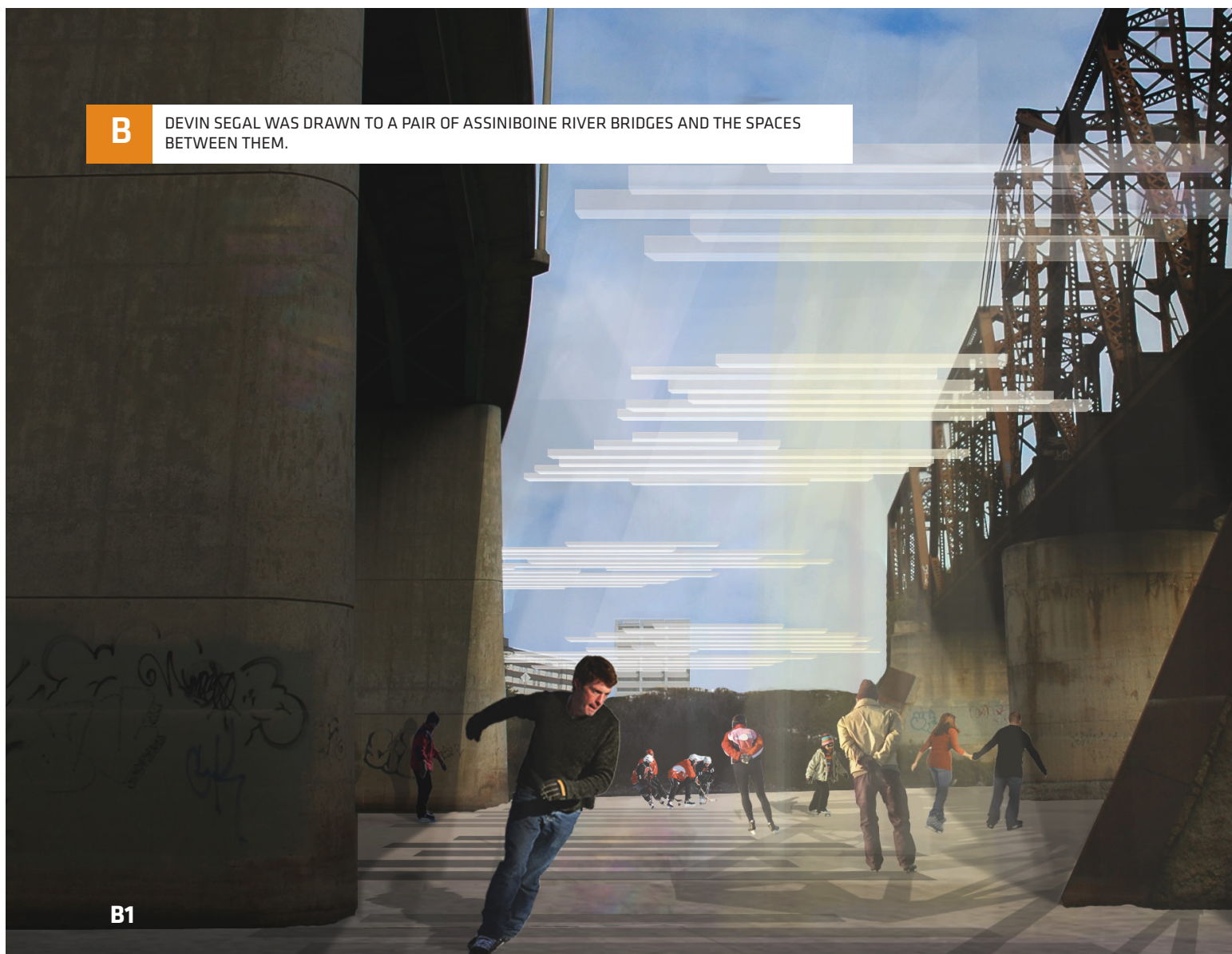

**B1**



A

SUPPLIED WITH A BENJAMIN MOORE FAN DECK, EMPLOYING PAINT-CHIP MATCHING AND PHOTOGRAPHY, EACH STUDENT DOCUMENTED HIS OR HER SITE AT FOUR DIFFERENT TIMES AT LEAST FIVE HOURS APART OVER AT LEAST TWO DAYS.

A1



A2



B

UNDER THE BRIDGE WITH DEVIN SEGAL

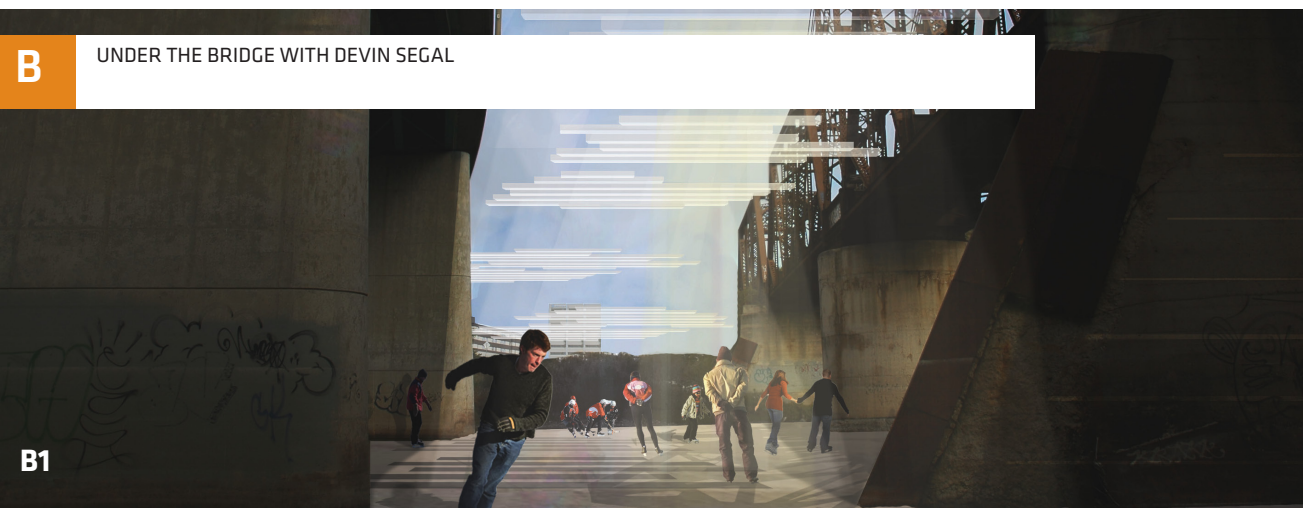

B1



C

BRET MACK PROPOSED FOUR GROVES FOR WHITTIER PARK ON THE RED RIVER, EACH DOMINATED BY A DIFFERENT SPECIES  
 --SCHUBERT CHOKECHERRY, BUR OAK, SWEDISH ASPEN, PAPER BIRCH \_

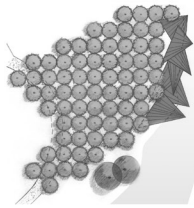

Those who choose to explore and make their way through the lush canopy of deep red and purple provided by a grove of Schubert Chokecherries will be rewarded with panoramas of downtown Winnipeg and the Red River that few experience. Bask in the soft red glow of the early morning light as it breaks through overhead or take shelter from the afternoon sun as it turns the canopy into a ceiling of deep purple. Series of colored benches fade into the background or explode into view dependent upon the time of day or season, providing space for contemplation and reflection on the dual nature of the sites context.

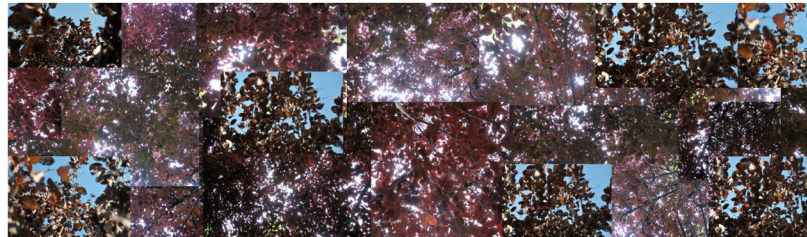

SCHUBERTS SECRET

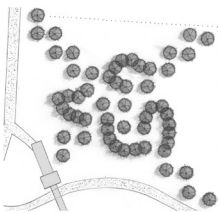

Orizzed branches stretch out overhead like gnarled fingers creating a layered, spacious canopy that shifts as you move through the space. Varying degrees of light filter through creating abstract images that dance upon the ground on days where breezes tickle the tree tops or glisten like tiny diamonds on the grass when all is still. As the sun plays off the wrinkled faces of the tree trunks intricate spaces are revealed, inviting people to examine dark in a way they never have before. Benches provide ample space to sit and relax beneath the painted canopy of vibrant oranges, greens and yellows that fall brings.

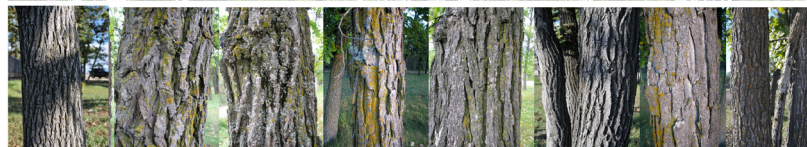

BUR OAK BOROUGHS



D

WU HUIJUN (JUNE)'S PROJECT CENTERED ON A NEW PATH SYSTEM AND ILLUMINATED FAN-FORMS ...



E

SHAWN STANKEWICH FOCUSED ON THE RAILROAD LIFT-BRIDGE IN WINNIPEG'S FORKS PARK ALREADY CONVERTED TO PEDESTRIAN USE.

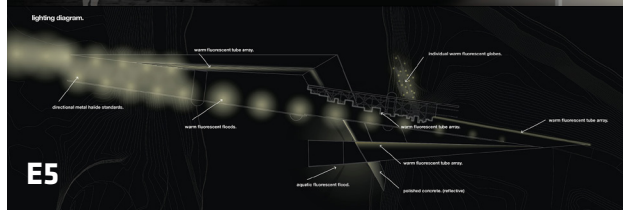
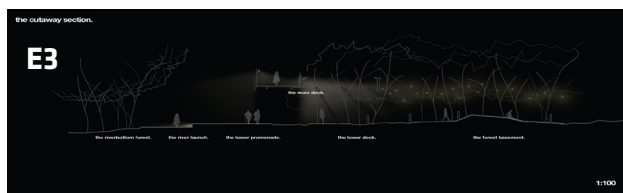

## forest light switch.

Within the forest basement, control boxes allow the user to turn off the overhead compact fluorescent globes with the flick of a switch. The box is a simple steel structure, four feet high, with a standard switch detail, just like the ones found in domestic homes. Embedded within the switch itself is a tiny LED. This light will turn on when the corresponding globe light is switched off, providing a beacon for those seeking the switch in the darkness of the forest.

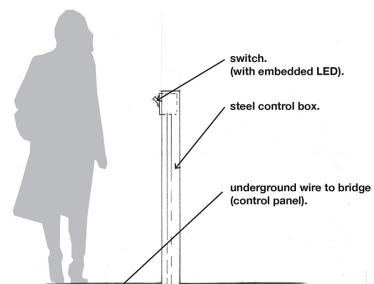



F1



F2



F3

F

JORI PINCOCK BECAME VERY INTERESTED IN THE HOMELESS COMMUNITY MAKING ITS HOME IN HER SITE AND IN BOTH HER DESIGNS SHE SOUGHT TO SUPPORT THEIR ACTIVITIES WHILE ALSO ACCOMMODATING THE GENERAL PUBLIC.



G1

G

CHELSEA SYNCHYCH'S DESIGN, LOCATED WHERE THE SEINE AND RED RIVERS MEET, WAS AN EXERCISE IN MINIMAL AND INDIRECT LIGHTING.

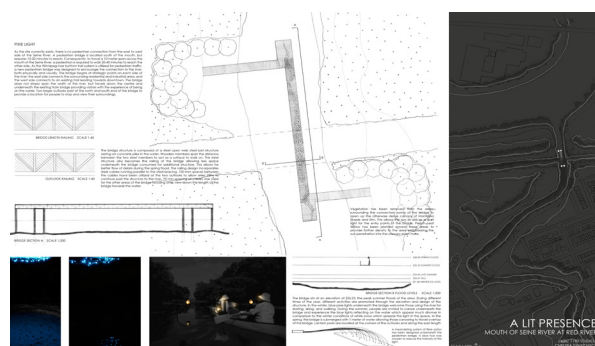

G2

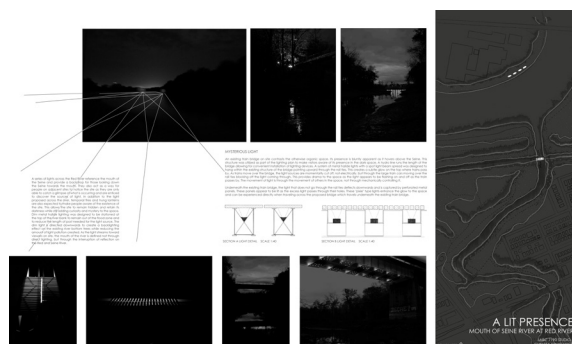

G3